



Your Storage Place™

AT W KINGSLEY ROAD

U-HAUL STANDARD ADVANTAGES

- NO DEPOSIT OR ADMINISTRATIVE FEES
- Electronically Controlled Access
- Personal Access Card
- FREE** Online Account Management
- FREE** Climate Controlled Storage
- Drive-Up Loading and Unloading
- 24-Hour Video Monitoring
- FREE** Automatic Payment Plans
- 10' Extra Tall Rooms
- Resident Management
- Indoor Storage: Twice the Protection and Security
- FREE** Use of Loading Carts
- Convenient Elevator Use
- Fire Protected: Sprinklers and Alarms
- A Room For Every Need

OPTIONAL SERVICES

- Extended & 24-Hour Access \$ 5 and up per mo.
- Storage Insurance \$ 6 and up per mo.
- Package Signing & Receiving Per Box/Per Mo.
- Dumpster Use \$ 6 and up per use



Michele & Michael Munoz

General Managers
Team Members Since 2009



Size	Rate	YOUR ROOM #
5 x 5	\$ 39 ⁹⁵	
5 x 10	\$ 59 ⁹⁵	
10 x 10	\$ 89 ⁹⁵	
10 x 15	\$119 ⁹⁵	

Room sizes are approximated

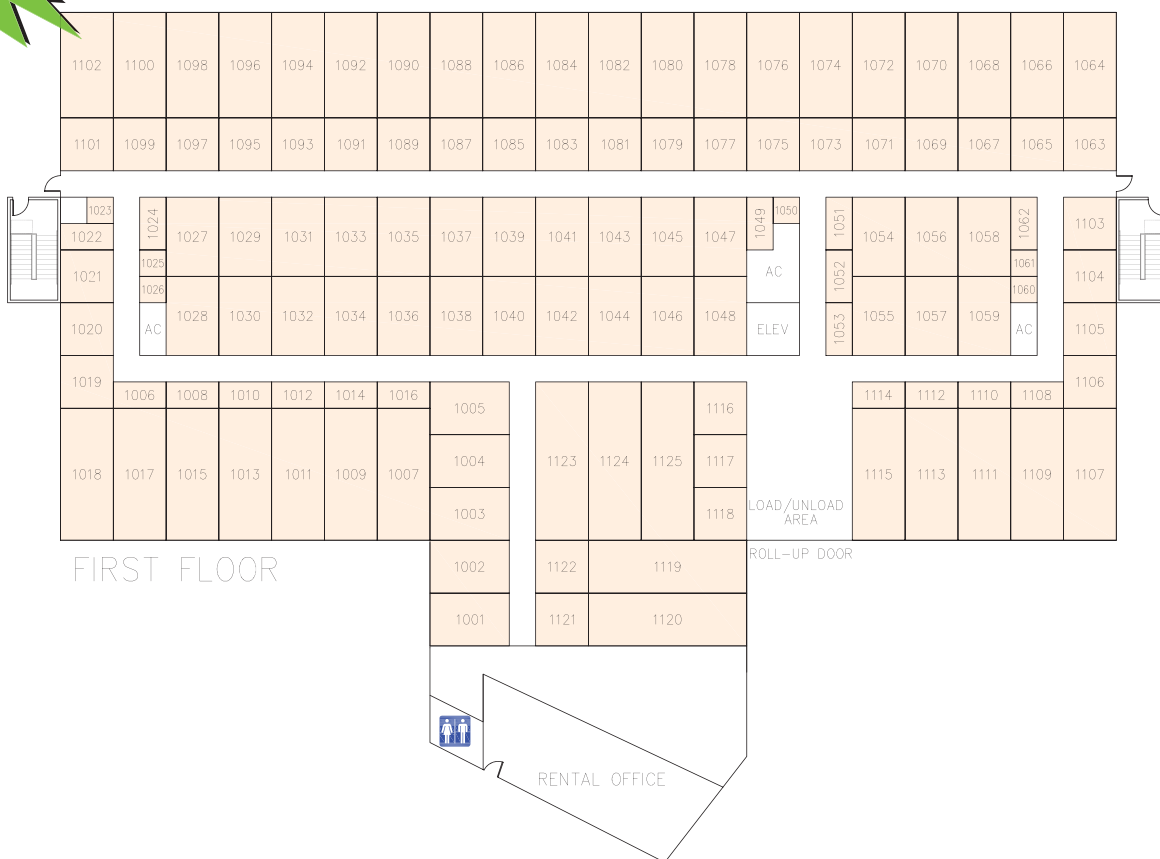

U-Haul® Moving & Storage at W Kingsley Rd

11383 Amanda Ln (between Kingsley & Jupiter Rd.)

Dallas, TX 75238 - (214) 340-4331

E-Mail: michele_munoz@uhaul.com

Mon-Thurs & Sat 7am-7pm ♦ Friday 7am-8pm ♦ Sunday 9am-5pm

uhaul.com

or call 1-800-GO-UHAUL



**U-BOX:
PORTABLE
MOVING & STORAGE**



2014	2015	2016	2017	2018	2019	2020	2021	2022	2023	2024	2025	2026	2027	2028	2029	AC	2030	2031	2032				
2013	2177	2178	2180	2182	2184	2186	2188	2190	2192	2194	2196			2202	2204		2208	2210	2033				
2012	2176													2203	2205	2207		2211	2034				
2011	2175	2179	2181	2183	2185	2187	2189	2191	2193	2195	2197	2199	2201				2209	2212	2035				
2010	2174																	2213	2036				
2009	2173												2145	AC	2144			2135	2037				
2008	2172	2167	2165	2163	2161		2157	2155	2153	2151	2149	2147		2146	2143	2140	2138	2136	2038				
2007	2171				2160										2142	2141	2139	2137	2039				
2006	2170													ELEV				2132	2040				
2005	2169	2168	2166	2164	2162		2158	2156	2154	2152	2150	2148			2142	2141	2139	2137	2041				
2004																		2131	2042				
2003	2067	2068	2070	2072	2074	2076	2078	2080	2082	2084	2086	2088	2090	2092	2094	2096	2098	2100	2102	2104	2106	2108	2110
2002	2066	2069	2071	2073	2075	2077	2079	2081	2083	2085	2087	2089	2091	2093	2095	2097	2099	2101	2103	2105	2107	2109	2111
2001	2065	2068	2070	2072	2074	2076	2078	2080	2082	2084	2086	2088	2090	2092	2094	2096	2098	2100	2102	2104	2106	2108	2110
2064	2063	2062	AC	2061	2060	2059	2058	2057	2056	2055	2054	2053	2052	2051	2050	2049	2048	2047	2046				

SECOND FLOOR

3014	3015	3016	3017	3018	3019	3020	3021	3022	3023	3024	3025	3026	3027	3028	3029	AC	3030	3031	3032				
3013	3177	3178	3180	3182	3184	3186	3188	3190	3192	3194	3196	3198	3200			3202	3204	3206	3210	3033			
3012	3176															3203	3205	3207	3209	3211	3034		
3011	3175	3179	3181	3183	3185	3187	3189	3191	3193	3195	3197	3199	3201						3212	3213	3035		
3010	3174																			3213	3036		
3009	3173												3145	AC	3144				3135		3037		
3008	3172	3167	3165	3163	3161	3159	3157	3155	3153	3151	3149	3147		3146	3143	3140	3138	3136	3134		3038		
3007	3171														3142	3141	3139	3137	3133		3039		
3006	3170													ELEV					3132		3040		
3005	3169	3168	3166	3164	3162	3160	3158	3156	3154	3152	3150	3148			3142	3141	3139	3137	3131		3041		
3004																						3042	
3003	3067	3068	3070	3072	3074	3076	3078	3080	3082	3084	3086	3088	3090	3092	3094	3096	3098	3100	3102	3104	3106	3108	3110
3002	3066	3069	3071	3073	3075	3077	3079	3081	3083	3085	3087	3089	3091	3093	3095	3097	3099	3101	3103	3105	3107	3109	3111
3001	3065	3068	3070	3072	3074	3076	3078	3080	3082	3084	3086	3088	3090	3092	3094	3096	3098	3100	3102	3104	3106	3108	3110
3064	3063	3062	AC	3061	3060	3059	3058	3057	3056	3055	3054	3053	3052	3051	3050	3049	3048	3047	3046				

THIRD FLOOR

— CLIMATE CONTROLLED

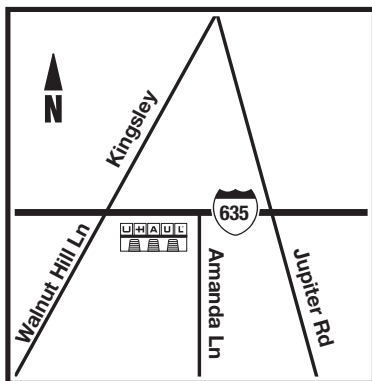

DIRECTIONS FROM I-635

From East on I-635 - Take the Kingsley/Jupiter Rd. exit (Exit 13) turn right on Jupiter Rd., then turn left on Kingsley Rd / Walnut Hill Ln
turn left, take the access road to Amanda Ln

From West on I-635 - Take the Walnut Hill/Kingsley/Jupiter Rd exit (Exit 13) stay on the access road to Amanda Ln