



Your Storage Place™ OF COLMAR



Jason Ibbetson

General Manager
Team Member Since 2007

U-HAUL STANDARD ADVANTAGES

- NO DEPOSIT OR ADMINISTRATIVE FEES**
- Indoor Storage: Twice the Protection and Security**
- 24-Hour Video Monitoring**
- Controlled Access for Your Protection**
- Covered Loading and Unloading**
- FREE Use of Loading Carts**
- A Room For Every Need**
- Your Lock/Your Key**
- Affordable Rates**
- FREE Online Account Management**
- FREE Automatic Payment Plans**

Located on RT 309, 2 miles north of Rt 202

OPTIONAL SERVICES

- Package Signing & Receiving** Per Box/Per Mo.
- Storage Insurance** \$ 6 and up per mo.
- Dumpster Use** \$ 8 and up per use
- On Premises Parking** \$ 25 w/ storage room rental

| Size | Rate | YOUR ROOM # |
|---------------|---------------------------|-------------|
| 4 x 8 | \$ 44⁹⁵ | |
| 6 x 8 | \$ 54⁹⁵ | |
| 8 x 8 | \$ 64⁹⁵ | |
| 8 x 11 | \$ 79⁹⁵ | |

Room sizes are approximated

RV/VEHICLE STORAGE

| Size | Rate |
|----------------|---------------------------|
| 10 x 20 | \$ 49⁹⁵ |
| 10 x 40 | \$ 64⁹⁵ |

Room sizes are approximated

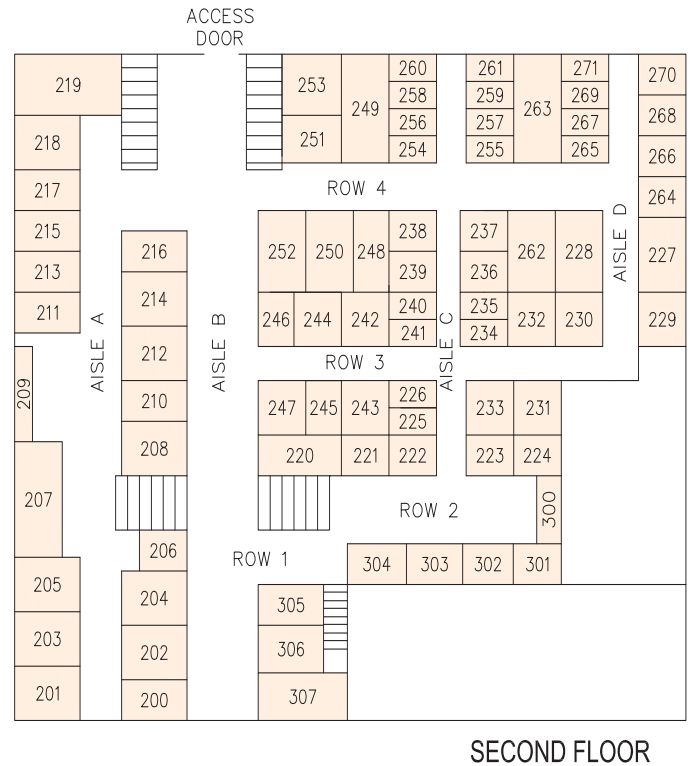

U-Haul® Moving & Storage of Colmar
 250 Bethlehem Pike (Rt. 309), Colmar, PA 18915 - (215) 822-8080
 E-Mail: jason_ibbetson@uhaul.com
 Mon-Thurs & Sat 7am-7pm ♦ Friday 7am-8pm ♦ Sunday 9am-5pm



**U-BOX:
PORTABLE
MOVING & STORAGE**



